



HOUSEHOLD PRODUCTS

11/30/2000

"4 IN 1" KITCHEN CENTER

"5 IN 1" KITCHEN CENTER

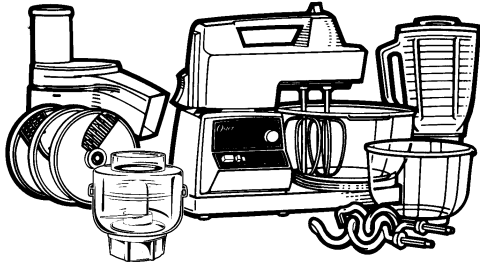

	1995
X	PART NO.

2726-1 (OLD 979-28) - OB		X			
2725-1 (OLD 979-23) - OB			X		
2743 - OB				X	
2771 - DI					X
BASIC PARTS	X				

120V., 450W., 60HZ.

KEY #	DESCRIPTION	STATUS	PART #	QUANTITY REQ'D				
				1	2	3	4	5
***	MIXER ARM		033089-000-000	1				
***	FOOD CRAFTER		033088-010-000	1				
***	FOOD PROCESSOR #1		033143-005-000			1		
1	CONTAINER ASSY. - GLASS		STYLE G ***		1	1	1	
8	PIVOT - CAST ZINC - LEFT	OB	027718-000-000	1				
9	PIVOT - CAST ZINC - RIGHT	OB	027719-000-000	1				
10	CONTAINER HOLDER - DK. GRAY		014906-000-809	1				
11	SQUARE DRIVE ASSY.	OB	024771-005-000	1				
12	DRIVER ASSY.		024596-000-805	1				
13	COUPLING		015218-005-000	1				
16	SCREW - #6-20 x 3/8"		014335-000-000	3				
18	BRACKET INDICATOR		014698-000-090	1				
20	SWITCH - 3 PUSHBUTTON	OB	014477-005-000	1				
21	SWITCH BLOCK		014466-000-809	1				
22	SCREW - #6-20 x 1/2"		014336-030-000	2				
24	KNOB - WHITE		014408-925-805	1				
25	NAMEPLATE - LOWER	OB	030690-000-000	1				
26	NAMEPLATE - UPPER	DI	030686-000-000	1				
27	DRIVER - BELT	OB	026109-000-085	1				
28	BASE - WHITE	OB	014678-000-805	1				
29	SCREW - #10-16 x 3/4"		014330-000-000	4				
45	BUMPER - FOOT		022835-005-000	6				
46	SCREW - #8-18 x 5/8"		014344-005-000	8				
50	MOTOR ASSY.	DI	014708-061-000	1				
51**	BRUSH ASSY.		014931-002-000	1				
70	BASEPLATE	OB	014781-000-000	1				
71	CORD BUSHING	OB	017322-000-000	1				
72	CORD & PLUG ASSY.	OB	002678-613-818	1				
78	SCREW - #6-20 x 5/8"	OB	014334-000-000	2				
79	"O" RING		024919-000-000	1				
86	SEAL	OB	027191-000-000	1				
**	INST. BOOK		026322-010-000	1				

\*\* NOT SHOWN ON DRAWING

\*\*\* SEE KITCHEN CENTER ATTACHMENTS

DI - DISCONTINUED ITEMS

OB - OBSOLETE ITEMS

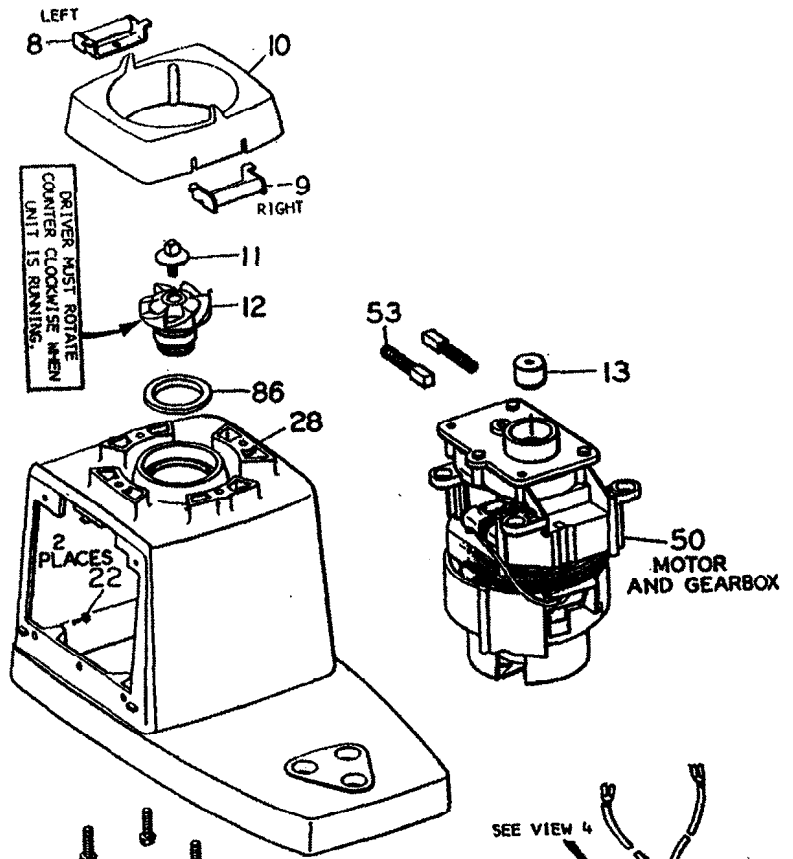
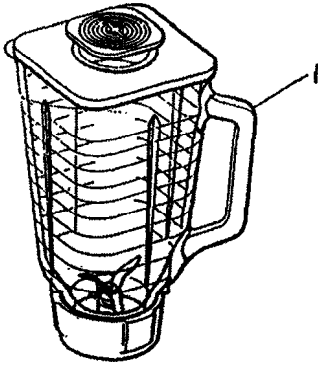

**CORD KNOT LOCATION**

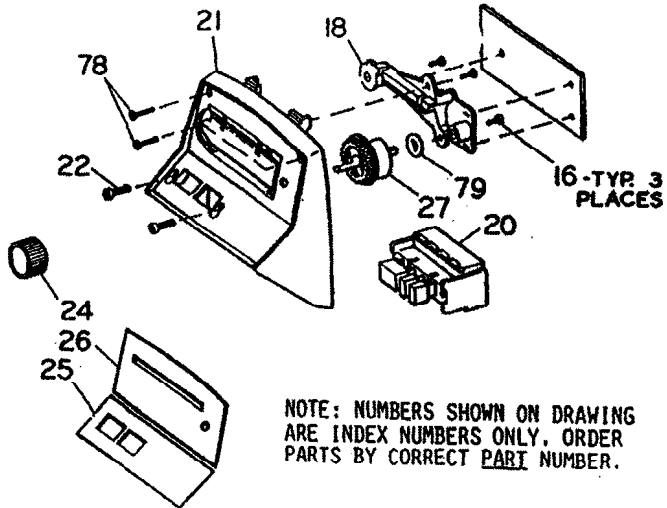
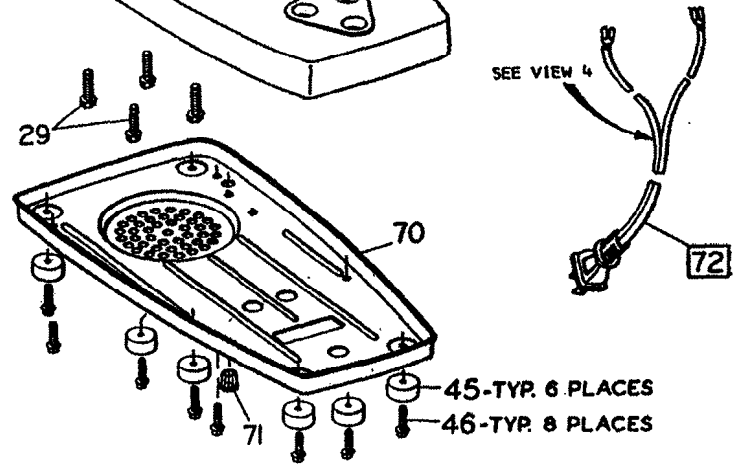
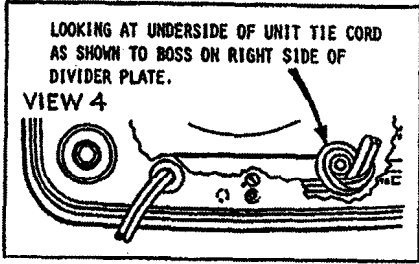

NOTE: NUMBERS SHOWN ON DRAWING ARE INDEX NUMBERS ONLY. ORDER PARTS BY CORRECT PART NUMBER.





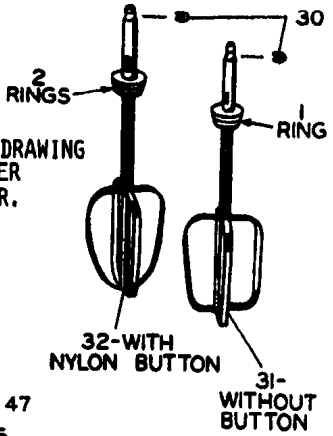
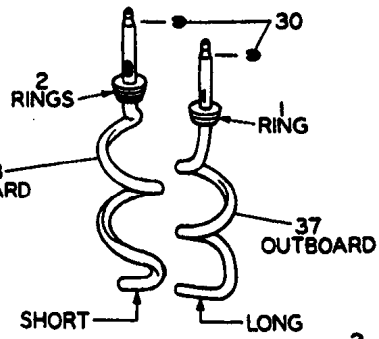
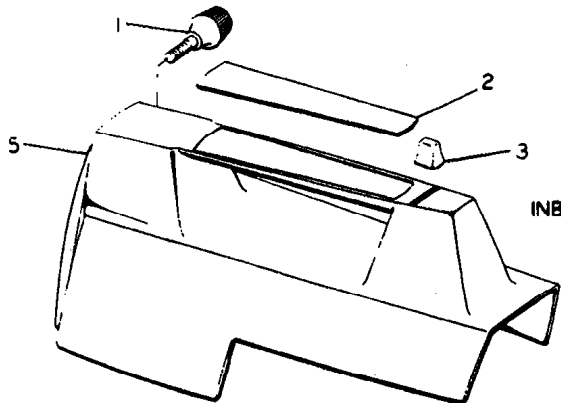

APPLY GREASE #349 TO AREAS INDICATED

CAUTION: NUMBERS SHOWN ON DRAWING ARE INDEX NUMBERS ONLY. ORDER PARTS BY CORRECT PART NUMBER.

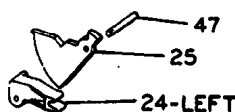
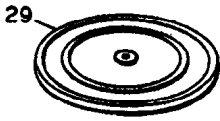
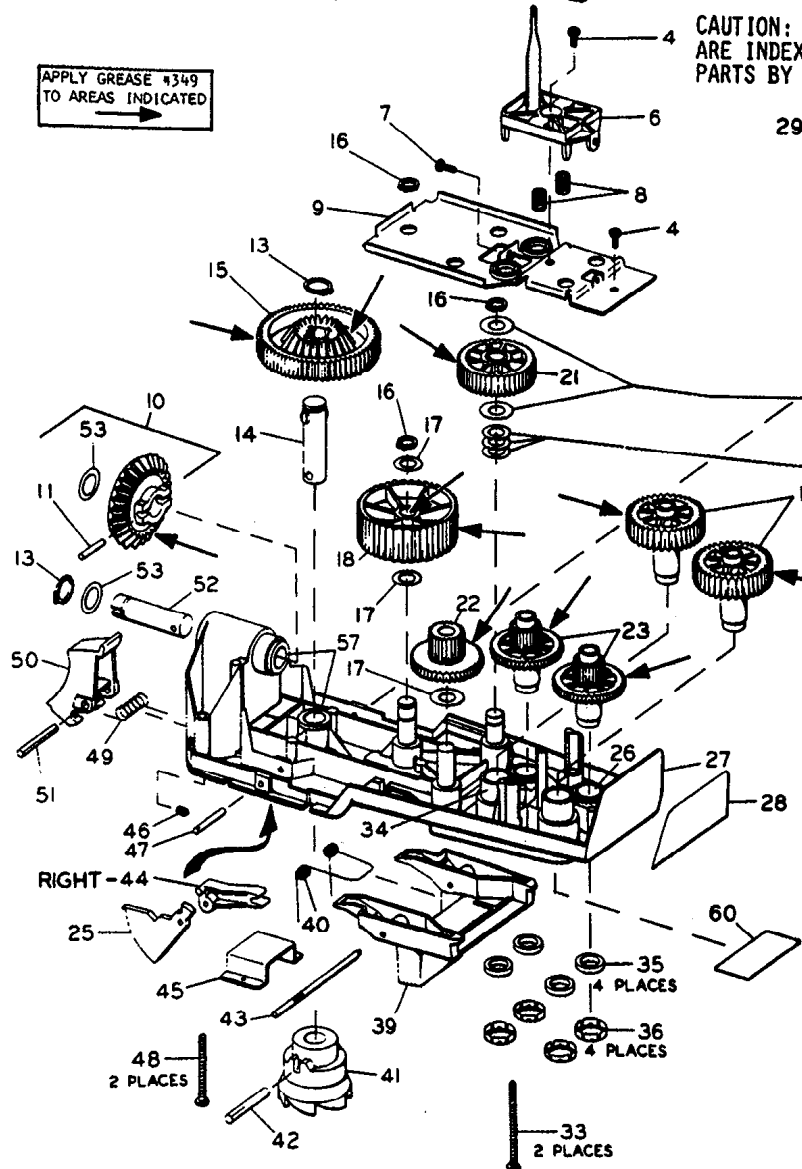

USE INDEX #17 AS REQ'D. TO ACQUIRE .003 - .017 END PLAY.

USE INDEX #59 AS REQ'D. ON THIS SIDE OF GEAR ONLY TO MAINTAIN .015 MIN. CLEARANCE BETWEEN SPINDLE TIMING MARKS & GEAR WHEN SPINDLE GEAR INDEX #23 IS IN THE UPPERMOST POSITION AND THE IDLER GEAR INDEX #21 IS IN THE LOWERMOST POSITION.

55 LARGE

56 SMALL

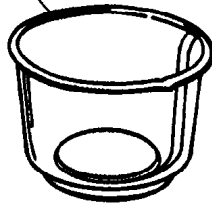
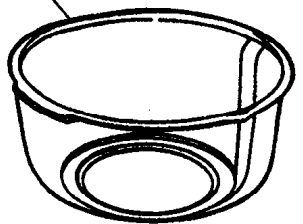

35 4 PLACES

36 4 PLACES

33 2 PLACES



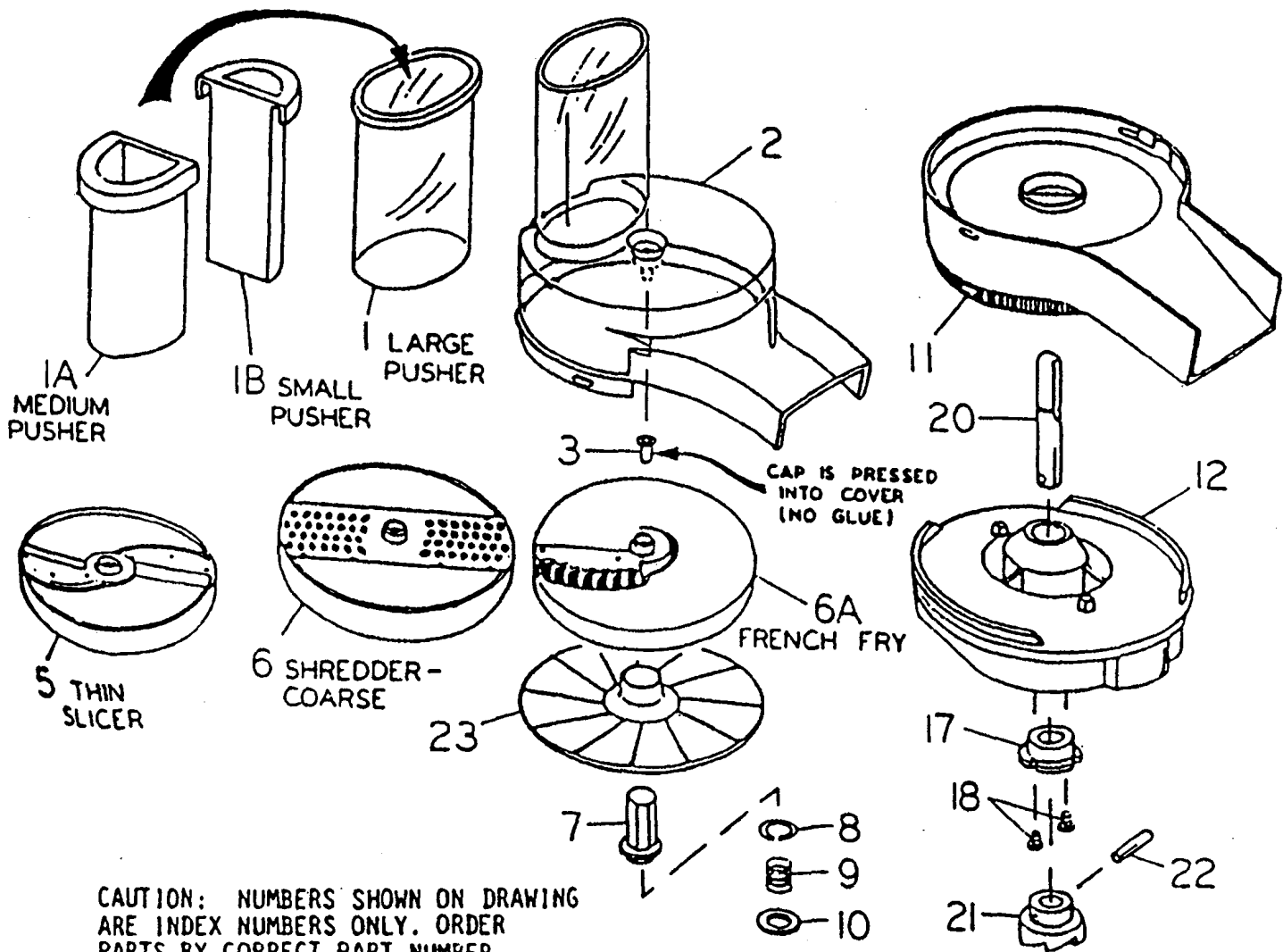

CAUTION: NUMBERS SHOWN ON DRAWING  
 ARE INDEX NUMBERS ONLY. ORDER  
 PARTS BY CORRECT PART NUMBER.



VIEW 1

