

Age Range: 3-7 Yrs.
 Weight Limit: 65 Lbs.
 Surfaces: Hard, Grass & Carpet
 Speed: 3.5 MPH Forward
 3.5 MPH Reverse
 Colors: Red Body
 Black Wheels
 Black & White Trim
 Intro: 1990
 Warranty: 90 Days Vehicle
 6 Months Battery

This product is affected by the PW recall announced Oct 1998.
 Please confirm that the product is modified or remediated in
 accordance with policy.

76190-9993 / 85500

**Fire Truck
 Super 6 Volt**

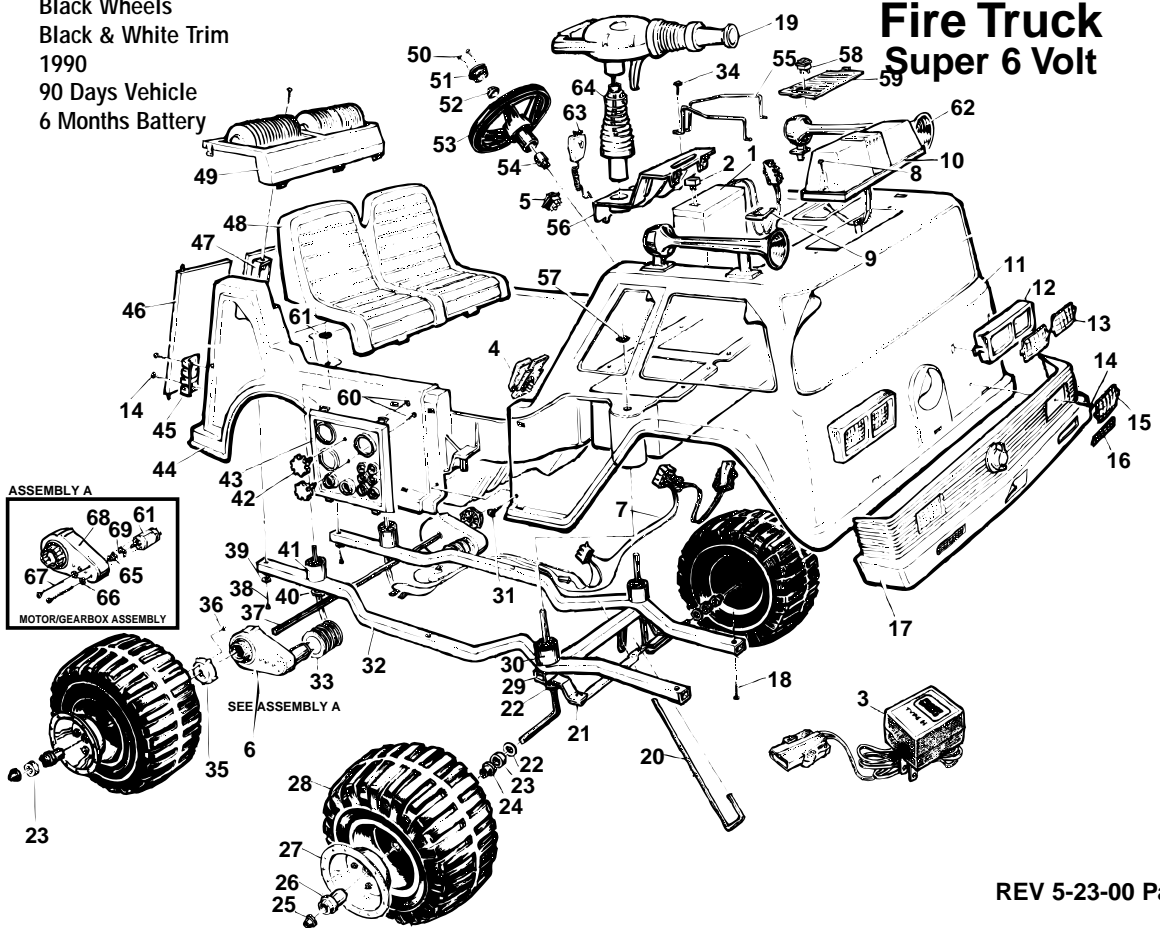

REV 5-23-00 Pav

Item No.	Description	Part No.	Qty.	Item No.	Description	Part No.	Qty.	Item No.	Description	Part No.	Qty.
1	**Battery, Type H	0801-0431	1	25	.437 Cap Nut	0801-0214	4	53	Steering Wheel	74440-2379	1
2	Thermal Fuse	0801-0153	1	26	Hex Bushing w/Extension	80009-0001	4	54	Steering Column Bushing	75560-2259	1
3	** Charger, Super 6 (Type H)	0801-0237	1	27	Hubcap	74590-2579	4	55	Battery Retainer (N/A)	80047-0004	1
4	Footboard Assembly	76817-9159	1	28	Wheel	76188-2459	4	56	Battery Door (N/A)	80018-0003	1
5	** Control Switch	80014-0073	1	29	Front Frame Support (N/A)	80051-0021	1	57	.437 Retainer w/o Body	0801-0214	2
6	3B Motor/Gearbox Assy	75560-0640	2	30	Front Bushing	73233-2539	2	58	Siren Switch (N/A)	80014-0074	1
7	** Wiring Harness (N/A)	80064-0045	1	31	Christmas Tree Fastener (N/A)	80010-0018	2	59	Switch Plate (N/A)	80001-0029	1
8	#8 x 3/4" Phillips Panhead Screw	0801-0223	2	32	Siderail (N/A)	80051-0023	2	60	#6 x 3/8" Trusshead Screw	0801-0219	4
9	Battery U-Clip	74570-2669	1	33	Motor Cover	76803-2489	2	61	Motor w/pinion	74580-9539	2
10	Siren (N/A)	80030-0021	1	34	#8 x 7/8" Trusshead Screw	0801-0228	1	62	Horn	80032-0008	2
11	Front Body (N/A)	80005-0055	1	35	Driver	73233-2239	2	63	Microphone	73233-9479	1
12	Headlight Housing (N/A)	80030-0001	2	36	#10 x 1/2" Phillips Screw	0801-0255	2	64	Water Bottle	80001-0033	1
13	Headlight Lens (N/A)	80030-0007	4	37	Rear Axle Assembly	76817-4559	1	65	Motor Drive Gear	74550-2269	2
14	#8 x 1/2" Phillips Panhead Screw	0801-0202	7	38	#8 x 1-1/4" Plascrow	80006-0090	2	66	Star Washer	0801-0330	4
15	Bumper Light (Red) (N/A)	80030-0008	2	39	1-1/8" Fender Washer (N/A)	80061-0027	2	67	Motor Bolt	0801-0269	4
16	Parking Lights (N/A)	78640-2759	2	40	Washer, 5/16"	0801-0253	2	68	3B Gearbox	74550-9279	2
17	Grill Bumper (N/A)	80065-0001	1	41	Rear Bushing	73233-2549	2	69	D Lock Washer	0801-0329	2
18	#8 x 7/8" Phillips Panhead Screw (N/A)	80006-0086	2	42	Cluster Box Knobs	80014-0001	4	PARTS NOT SHOWN			
19	Water Cannon Assy (N/A)	76107-9439	1	43	Right Cluster Box (N/A)	80001-0091	1		Left Cluster Box (N/A)	80001-0090	1
20	Steering Column	74560-4239	1	44	Rear Body (N/A)	80005-0059	1		Siren Battery Cover	80030-0017	1
21	Steering Linkage	76817-4229	1	45	Taillight Set	78640-2279	1		Literature Bag (N/A)	80044-0126	1
22	Washer 7/16"	0801-0196	4	46	Rear Door Set	80018-0067	1		Decal Sheet	80017-0045	1
23	Wheel Spacer (N/A)	80052-0003	4	47	Rear Door Support/Stop (N/A)	80018-0016	1		Use & Care Manual	76190-CCCC	1
24	Round Bushing	74550-2689	2	48	Seat	76817-2309	1				
				49	Rear Panel Cover (N/A)	80057-0005	1				
				50	1" Plastilock Screw	0801-0224	2				
				51	Steering Wheel Cap	74550-2729	1				
				52	.354 Cap Nut	0801-0215	3				

** See Service Bulletin 138

