

## T3264 Jeep Hurricane

## 12 Volt Advanced Series

Age Range:	3+
Weight Limit:	130 lbs
Surfaces:	Ultimate Terrain
Speed:	2.5 Mph Forward/Reverse 5.0 Mph Forward Charcole Gray
Colors:	Body/Orange Seat
Intro:	2006
Suggested Retail:	\$399.99
Box Dimensions:	28.4x32.4x51 -- 96 lbs
Warranty:	One Year Vehicle Six Months Battery

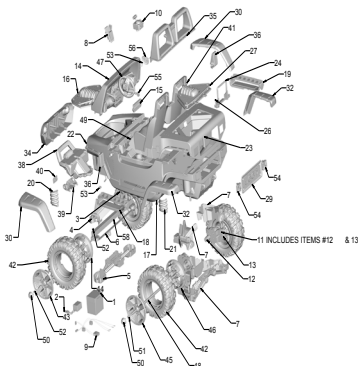

ITEM	PART #	DESCRIPTION	QTY	ITEM	PART #	DESCRIPTION	QTY
1	00801-1661	BATTERY, 12V (ORANGE TOP)	1 EA	29	N2273-2679	MESH, REAR	1 EA
2	00801-1480	CHARGER 12V PROBE	1 EA	30	3800-8198	FRONT FENDER SET	1 EA
3	N/A	CONTROL ARM, FRONT RIGHT	1 EA	32	3800-7994	REAR FENDER SET	1 EA
4	N/A	CONTROL ARM, FRONT LEFT	1 EA	34	T3264-9709	GRILLE ASSEMBLY	1 EA
5	N/A	SUSPENSION, FRONT	1 EA	35	J4394-9759	ROLLBAR ASSEMBLY	1 EA
6	J4394-9010	STEERING LINKAGE ASSEMBLY	1 EA	36	3800-8256	MIRROR SET (LEFT & RIGHT)	1 EA
7	N/A	REAR SUSPENSION ASSEMBLY	2 EA	38	K7112-9899	BRUSH GUARD ASSEMBLY	1 EA
8	J4394-9309	FOOTBOARD ASSEMBLY	1 EA	39	K7112-2879	LICENSE PLATE FRAME	1 EA
9	<b>K7112-9799</b>	<b>WIRING HARNESS</b>	<b>1 EA</b>	40	00801-1518	LARGE PW-EMBLEM	1 EA
10	J4394-9319	SHIFTER ASSEMBLY	1 EA	41	T3264-9909	SEAT ASSEMBLY	1 EA
11	<b>00968-2937</b>	<b>#7R MOTOR/GEARBOX ASM -</b>	<b>2 EA</b>	42	J4394-2529	WHEEL	4 EA
12	<b>00968-2716</b>	<b>#7R MOTOR/PINION ASM -</b>	<b>2 EA</b>	43	3800-8223	BAGGED FRONT RIMS, OUTER/INNER	1 EA
13	<b>00968-2822</b>	<b>#7R GEARBOX ASM -</b>	<b>2 EA</b>	44	*SEE# 43	BAGGED FRONT RIMS, OUTER/INNER	1 EA
14	3800-9042	WINDSHIELD/DASHBOARD W/RADIO	1 EA	45	3800-8224	BAGGED REAR RIMS, OUTER/INNER	1 EA
15	J4394-9559	BATTERY DOOR/SCREWS	1 EA	46	*SEE # 45	BAGGED REAR RIMS, OUTER/INNER	1 EA
16	N2273-9669	FALSE FRONT MOTOR ASSY W/MESH	1 EA	47	T3264-9989	STEERING WHEEL ASSEMBLY	1 EA
17	N/A	CHASSIS	1 EA	48	J4394-4519	REAR AXLE	1 EA
18	N/A	RUNNING BOARD, LEFT	1 EA	49	J4394-4459	STEERING COLUMN	1 EA
19	N/A	RUNNING BOARD, RIGHT	1 EA	50	T3264-2959	HUBCAP	4 EA
20	N/A	FRONT SHOCK/SPRING	2 EA	51	J4394-2149	WHEEL RETAINER .750	2 EA
21	N/A	REAR SHOCK/SPRING	2 EA	52	00801-1621	FRONT AXLE CAP .437	4 EA
22	N/A	BODY	1 EA	53	00801-1565	STEERING PIN	1 EA
23	3800-9002	REAR CLIP	1 EA	54			2 EA
24	3800-7809	BATTERY RETAINER	1 EA	55	J4394-2269	KEY	1 EA
26	00801-1200	SCREW, SELF TAPPING	2 EA	56	T3264-2789	STEERING WHEEL CAP	1 EA
27	N2273-9669	FALSE REAR MOTOR ASSY W/MESH	1 EA	57	00801-1620	STEERING COLUMN CAP	1 EA
<b>Parts Not Shown</b>			58	J4394-4419	CROSSBAR	1 EA	
J4394-4009	BUSHING SLEEVE	2 EA	<b>Parts Not Shown</b>				
J4394-9269	HARDWARE BAG	1 EA	<b>00801-1566</b>	<b>FOOTSWITCH</b>	<b>1 EA</b>		
T3264-9259	PARTS BAG	1 EA	74440-5349	SEATBELT LAP STYLE	1 EA		
T3264-0310	MAIN LABEL SHEET	1 EA	0801-0196	WASHER - 7/16"	2 EA		
J4394-4509	FRONT AXLE	2 EA	<b>* #7R parts can not be substituted with older models</b>				
<b>00801-0923</b>	<b>ROCKER SWITCH</b>	<b>2 EA</b>	3/30/2010 16:25				

